

**DO NOT USE G.I.S. MAPS OR PLANS FOR DESIGN PURPOSES, OR SCALE DIMENSIONS FROM THIS DRAWING.**

This map is reproduced from Ordnance Survey material with the permission of Ordnance Survey on behalf of Her Majesty's Stationery Office Crown Copyright 2020. Unauthorised reproduction infringes Crown copyright and may lead to prosecution or civil proceedings. © Crown Copyright and database right 2020. Ordnance Survey 100023383. East Riding of Yorkshire Council.

Copyright is owned by East Riding of Yorkshire Council, who provides this map-based data for information purposes only for use internally by East Riding of Yorkshire Council. Use of this data is not permitted without the prior written consent of the Council through the Head of Asset Strategy. Whilst we try to ensure that it is up to date and accurate, we cannot guarantee its accuracy or completeness. Nor can we be held responsible for the misuse or misinterpretation of any information. We accept no liability for any loss, damage or inconvenience caused as a result of reliance upon or use of this data.

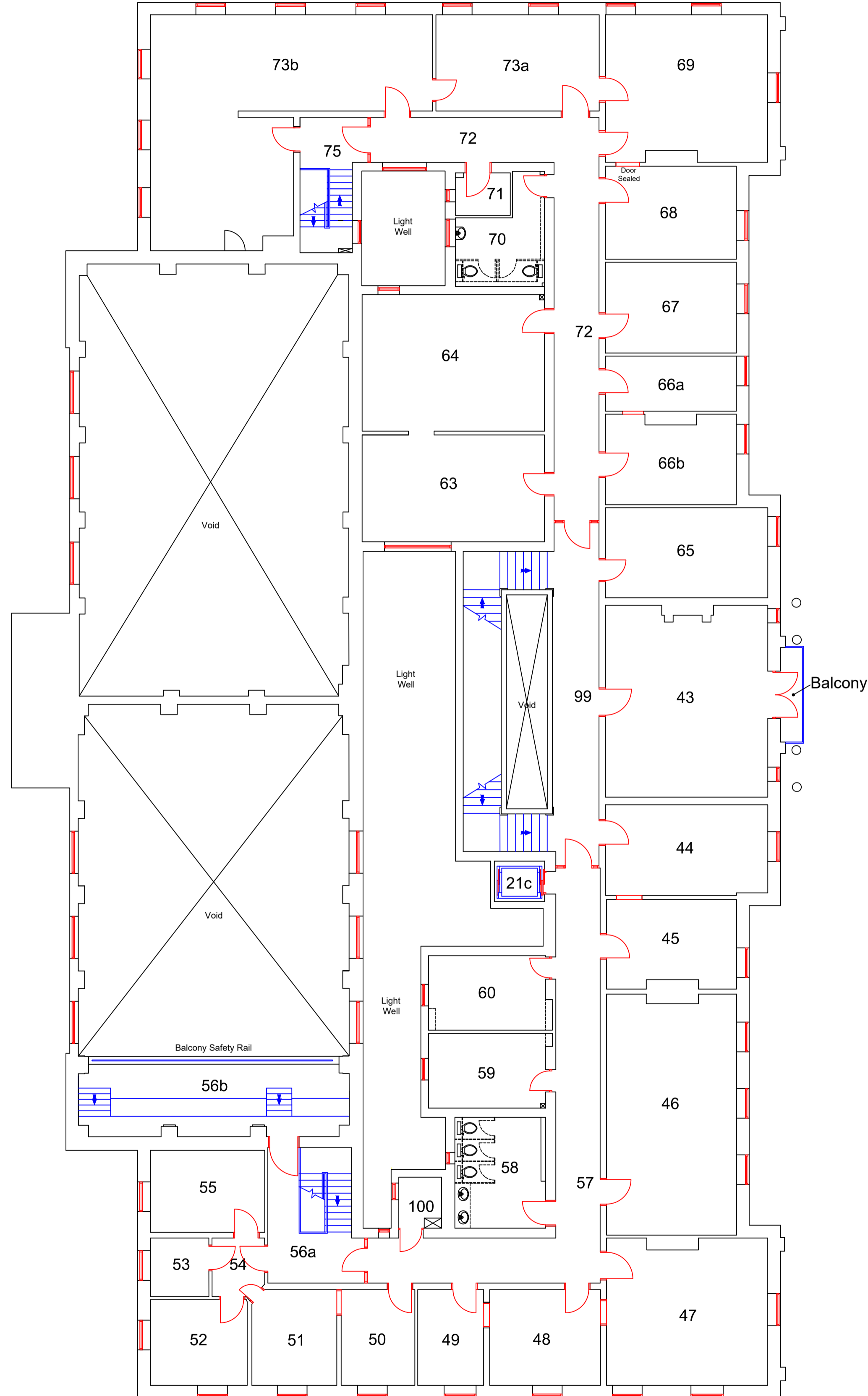

**Block A  
Office Block  
First Floor**

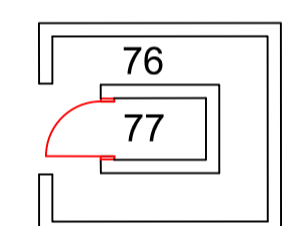

**Block A  
Office Block  
Second Floor  
(Clock Tower)**

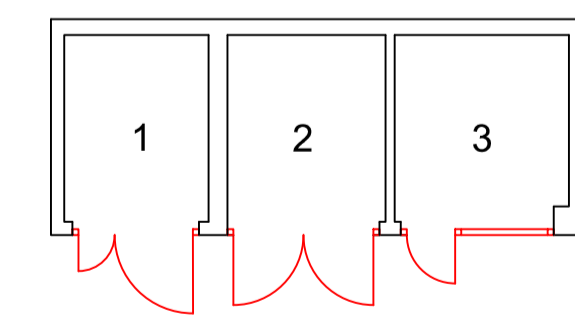

**Block B  
Store**

**Legend**

- Boundary of Property
- Building Outline
- A Building Block Reference
- - - - - Room Divides
- Roof Line Canopies (External)
- Pedestrian Access Ramp (-> up)
- Stairs or Steps (Arrow up)

**Block/Description**

- A Office Block
- B Store

Date	Surveyor	Revision
22.10.1996	J Marwood	
14.02.2001	R Nelder	
17.09.2004	S Howarth	
25.07.2006	A Dunn	
17.05.2007	C E Armitage	
29.05.2009	A Dunn	
11.06.2009	C E Armitage	
17.05.2010	R Worsfold	
01.06.2011	R Worsfold	
29.11.2012	A Dunn	
28.05.2014	R Worsfold	
20.12.2017	C E Armitage	

**EAST RIDING**  
OF YORKSHIRE COUNCIL

**HEAD OF ASSET STRATEGY**

COUNTY HALL, BEVERLEY, EAST YORKSHIRE, HU17 9BA  
Tel No: (01482) 393951  
[www.eastriding.gov.uk](http://www.eastriding.gov.uk)

**Building Plans**

**17896697/L/BG/002**

**Town Hall Bridlington  
Council Offices**

Scale: **1:125** Property Code: **17896697**